

TAVSAN AVIARY SYSTEM

Features;



- *Very open design for easy movement of the birds to all levels of the system and especially the nest area
- *The nest floor has a unique mechanism to push possible nest eggs out of the nest before the nest closes at the end of the day
- *Equipped with a special perching profile in accordance with the natural behavior of the birds
- *Every part is designed to be easy to clean and dirt does not accumulate
- *The bottom section of the legs in the litter zone are made of stainless steel
- *External perching platforms and entrance stairs are modularly designed
- *Equipped with a multistage nipple line and feeder
- *As an option, the system can be equipped with manure drying ducts
- *Egg collection options:
 - a. Egg collection table
 - b. Egg collection lift
 - c. Egg collection elevator for nests and for system egg-belts
 - i. Optionally the system can be equipped with egg belts for automatic system egg collection
 - d. Egg collection rod conveyor onto the egg cross conveyor

Technical Data

| | |
|---|---|
| Unit Height | 2696 mm |
| Unit Width | 2500 mm |
| Unit Length | 2440 mm |
| Length per Segment | 1220 mm |
| Max Width with Approaching Tubes and Stairs | 3300 mm |
| Max Length of System | 135 m |
| Manure Belt Thickness | 1.2 mm |
| Manure Belt Motor | 1.5 kW (per tier) |
| Egg Collection Belt Thickness | 1.8 mm |
| Feed Trough (W x H) | 85 x 64 mm |
| Feeder Options | Chain feeder (other options available) |
| Hopper Capacity | 150 kg |
| Feed Chain Motor | 3-phase 1.5 HP 16 m/min (other options available) |
| Power Supply | 3-phase 230V 50Hz (other options available) |
| Egg Collection | Egg collection table / Egg collection lift / Egg collection elevator / Rod conveyor onto egg cross conveyor (other options available) |

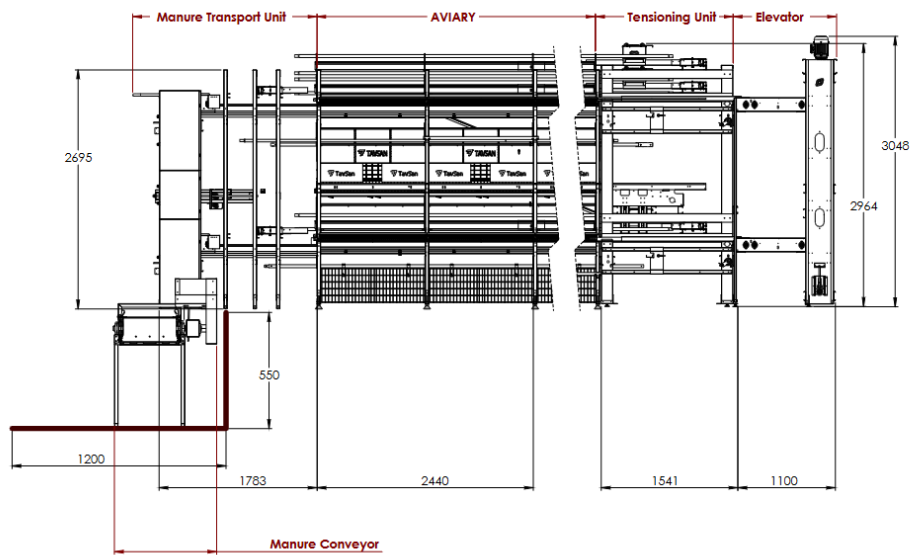
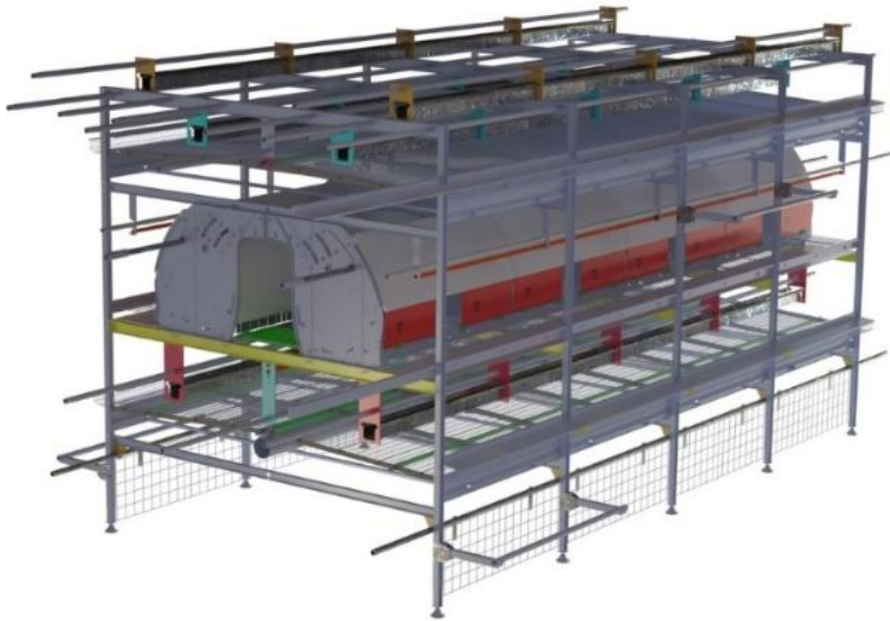

DETAILS OF PERCHING AREAS

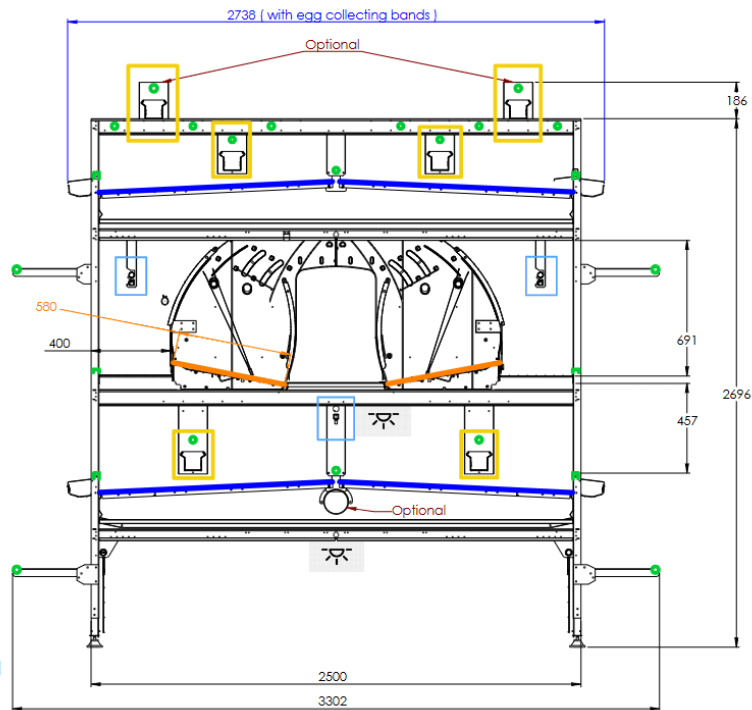
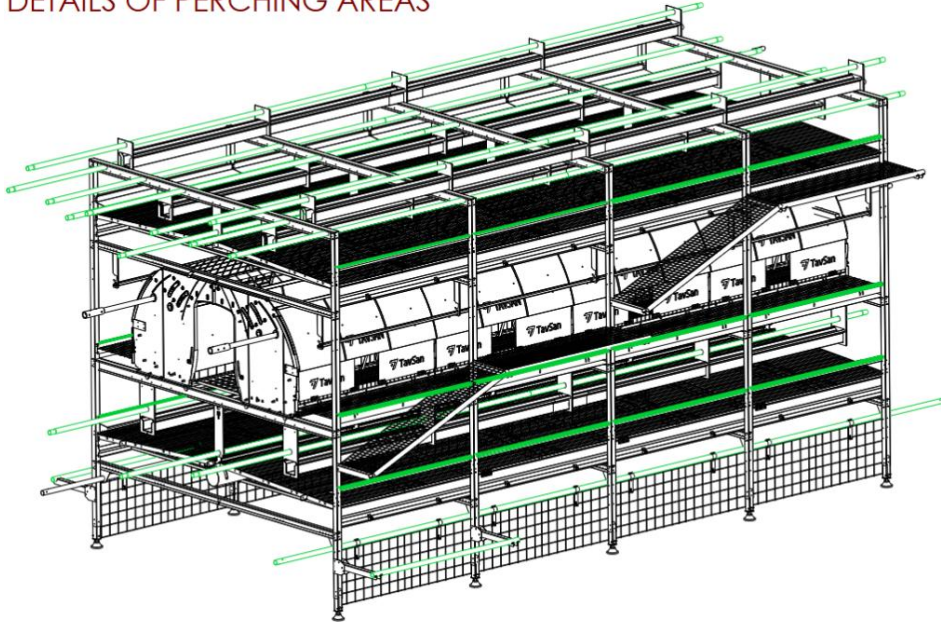

- Feeding
- Nippel Watering
- Nesting Area
- Usable Area
- Perching Area

Dimensions are in mm.